

TV521318

Caleffi 5213 20mm Tempering Valve with Cold Check Valve



Technical Specification

Temp Adjustment Range: 30 - 50°C

Temp Control: +/- 2°C

Max Operating Temp: 85°C

Recommended Working Pressure: 100 - 500kPa (balanced)

Operating Pressure Range: 20 - 500 kPa

Max. Inlet Pressure Differential: 6:1

Max Test Pressure: 1000 kPa

Min. Flow Rate: 4L/min

Material: DR Brass

Min. Operating Failsafe Temp. Differential: 10°C

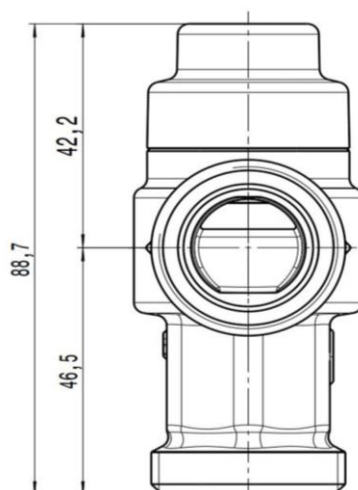
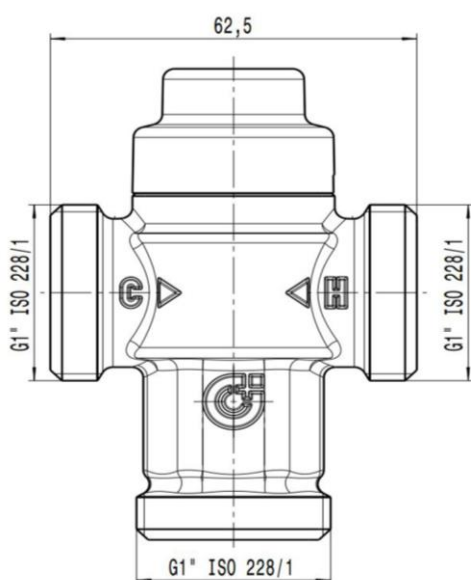

Warranty

5 years parts and labour

Features

For use on typical domestic hot water systems for a flow rate of up to 25L/min

Union connector with o-ring seal and cold check valve only

Notes;

NOT suitable for 'low pressure' systems. Use 'Low pressure tempering' version for systems less than 100kPa

Domestic 5213 series tempering valve used in standard COMBO sets