

WMBUS15SH

BMETERS 15mm MBUS Hot Meter



Technical Specification

- Below specifications measured at R100H↑:
- Overload Flow Rate Qmax: 3.12m³/h
- Permanent Flow Rate Q3: 2.5m³/h
- Transitional flow rate ±2%: 40l/h
- Min flow rate ±5%: 25l/h
- Min reading: 0.05l
- Max reading: 99.999m³
- Max admissible pressure MAP: 16bar



The meter can be installed according to what is indicated on the dial

- H: horizontal water flow
- V: vertical water flow
- ↑= dial on top
- = dial on the side

The meter can be installed with horizontal flow with the dial on the top, or on the side, or vertical with upwards or downwards flow. Horizontal installation with dial downward is prohibited.

Application

The BMETERS 15mm MBUS Hot Meter is used in plumbing systems to measure water quantity and is installed mostly in plant rooms.

Warranty

[Download the latest warranty statement](#)

Features

15mm MBUS ready, single jet, dry dial, direct reading hot water up to 90°C

- MBUS output via Optical interface
- Available with wired or wireless MBUS output using WMBUSWIRED5 or WMBUSWLESSS7
- Magnetic transmission
- Brass Body
- Complete with 15mm connection tails

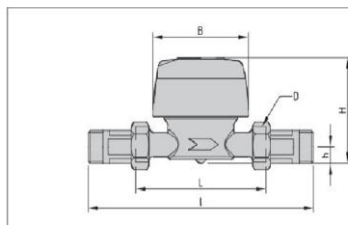

Calibro Size	mm	in	ts (t.27)
L	mm	110	
l	mm	190	
H	mm	73	
h	mm	18	
b	mm	85	
d	mm	3/4"	
Pesi Weight	with meters with unions	kg	0,65
	without meters without unions	kg	0,50

Installation position			
R 100H↑	R 50H→	R 50V	R 50H↓