

ASPEN SINKS

STAINLESS STEEL

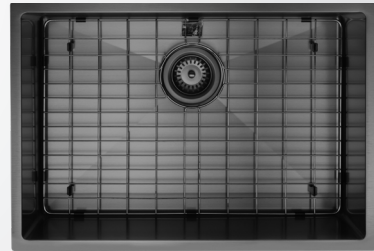

5 COLOURS | 5 SIZES

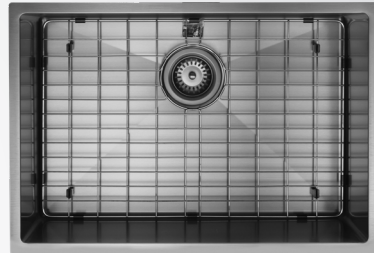
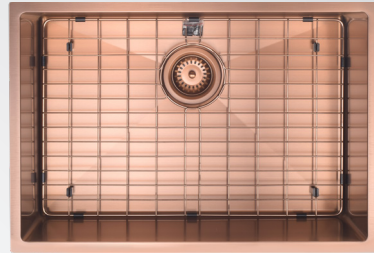
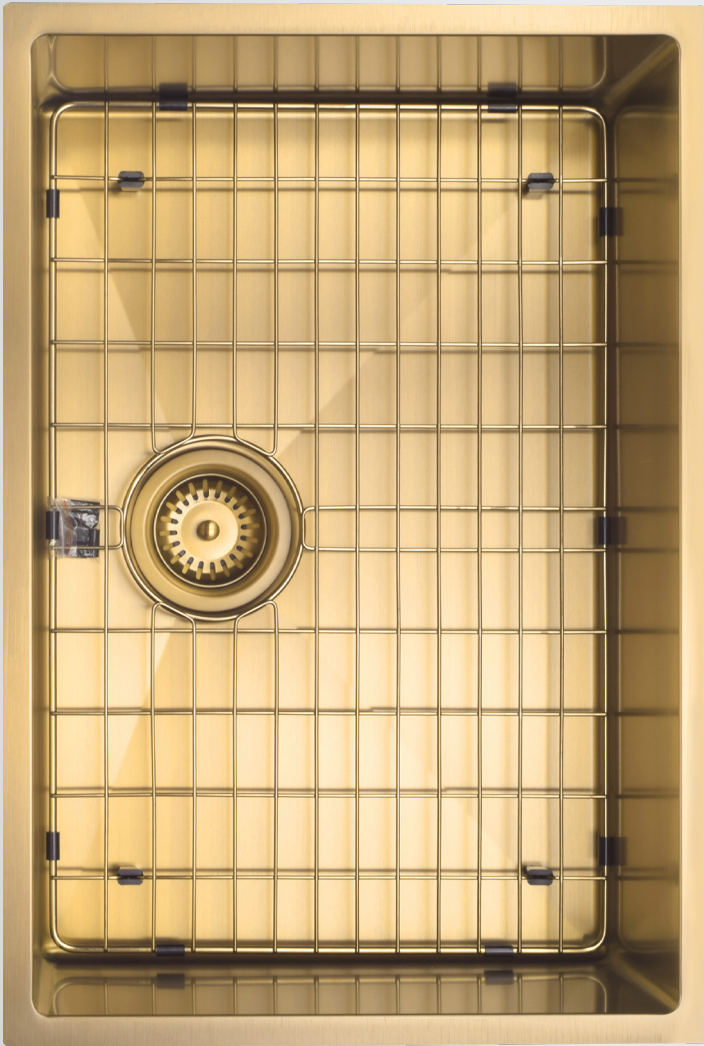

WATERWARE

waterware.co.nz

ABOUT **WATERWARE**

Since 1989, our passion has been delivering quality in all things plumbing, central heating and cooling, and bathroomware.

Waterware is proudly New Zealand owned and operated. From the outset we've been supporting the market with technical and design knowledge, helping deliver products and solutions that are functional, intuitive and beautiful.

Waterware are innovators setting the pace in New Zealand with hydronic radiant heating and cooling technology, high-performance plumbing fittings, and on-trend bathroomware.

What we do

Bathroom

Hand-picked from across the globe, our bathroomware delivers on design, quality and value

We've partnered with our factories to design products that Kiwis are proud to own. Introducing new materials and technologies to suit the local market, with clever design and longer warranties.

Radiant Heating & Cooling

Ditch noisy blasts of hot or frigid air, drafts, and dust. Waterware are leaders in radiant heating and cooling powered by hydronic solutions, with three technologies available for superior comfort in commercial and residential applications.

Plumbing

If you want clever designs, greater aesthetics, more sustainable material choices, and manufacturing processes that are considerate to our environment, then we have the products and solutions for you.

The Solutions Suite

In engineering, a bigger hammer would do it – but smarter problem solving does it better. Talk to us about innovation, and how we can solve your bathroom, plumbing, heating, and cooling issues with customised solutions.



Our commitment

We're on a mission to make lives easier with plumbing, central heating and cooling, and bathroomware solutions that look great and perform their best.

Waterware is constantly evolving to lead the market while reflecting our values of integrity, bold thinking, and genuine partnerships with everyone we interact with. We want to create environments of success for everyone involved.

We take special pride in our pre- and post-sales service experience, and our impressive network of business relationships around the world. Over the years, we've connected with thousands of like-minded partners to help us source products that suit our local market and perform better than any others.

Our products are supported by our extensive range of spare parts, and our in-house Installer Training and Warranty Assurance programmes, so you can rest assured that you'll be taken care of.

ABOUT

ASPEN STAINLESS STEEL SINKS

Add a touch of elegance to your kitchen with the Aspen stainless steel kitchen sink series.

The Aspen is a modern square design with all the benefits of stainless steel. With 10mm corner radius and is available in five colours: brushed copper, brushed gold, gun metal, black and brushed stainless - the Aspen is sure to match any decor.

But what really sets this sink apart from the rest is its PVD (Physical Vapour Deposition) finish and nano coating. It's one of the most environmentally friendly ways to color your sink, and it's far superior to other conventional coating methods

like electroplating or powder-coating. Whether you want modern chic or an industrial feel, this sink will be a stylish addition to any project.

Every Aspen sink includes sprayed sound insulation, waste & overflow kit, and protection rack for times of heavy use.

See back cover for additional items.

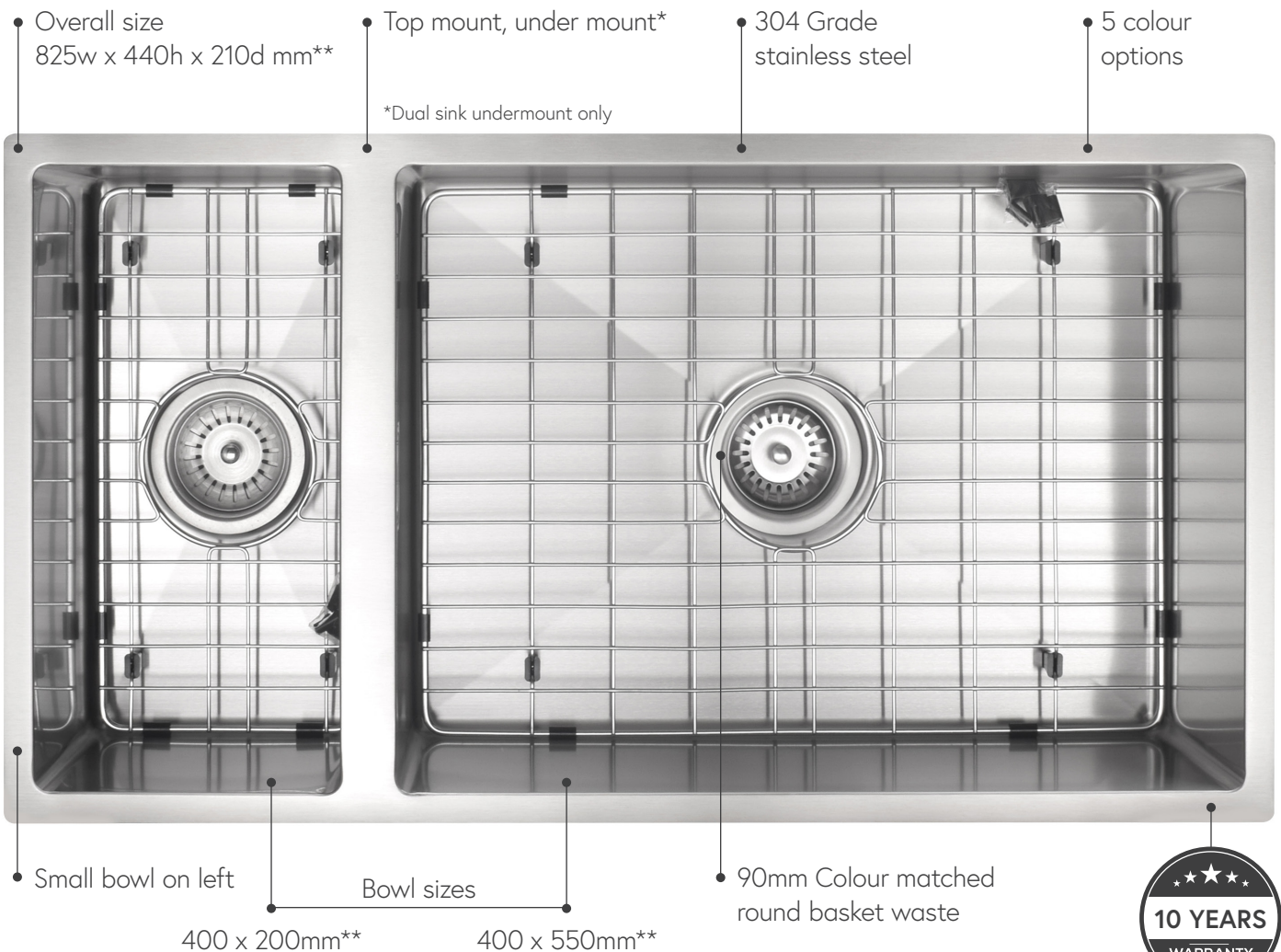

**Sizing is for Dual sink only.

● 304 STAINLESS STEEL
●
● **ASPEN 400 SINGLE KITCHEN SINK**
●

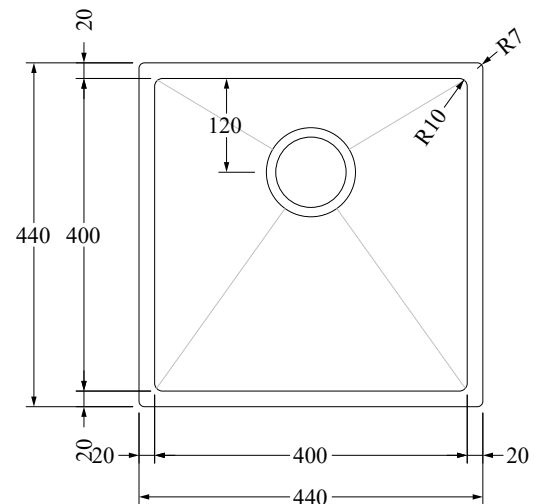
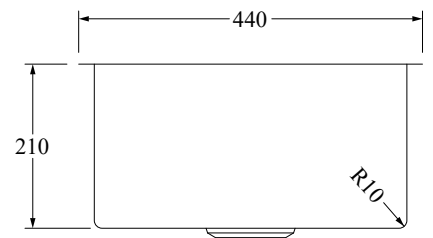

- 400w x 400h x 210d mm**
 AS44BB Brushed Brass
 AS44BC Brushed Copper
 AS44GM Gun Metal
 AS44MB Matte Black
 AS44SS Stainless Steel

● 304 STAINLESS STEEL
●
● **ASPEN 500 SINGLE KITCHEN SINK**
●

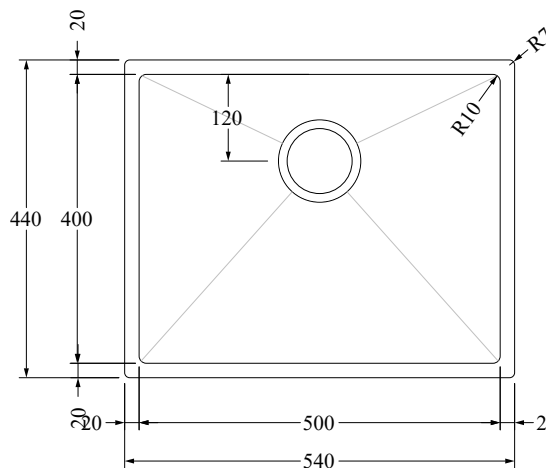
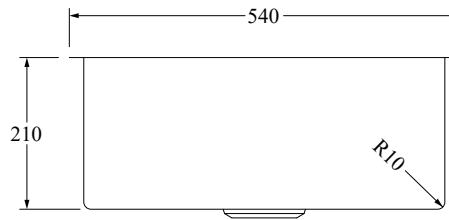
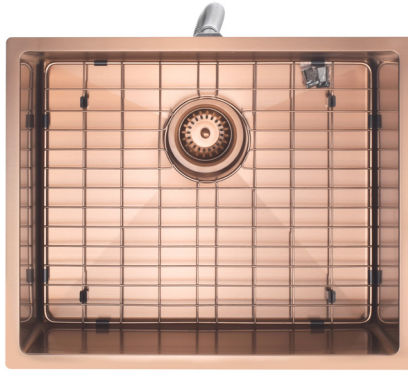
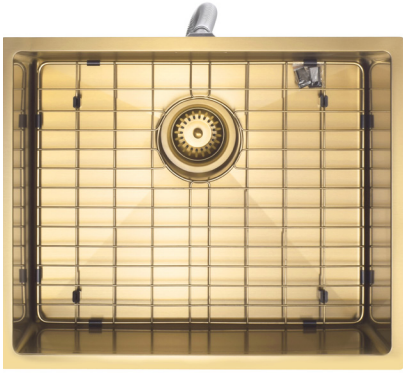

500w x 400h x 210d mm

- AS54BB Brushed Brass
- AS54BC Brushed Copper
- AS54GM Gun Metal
- AS54MB Matte Black
- AS54SS Stainless Steel

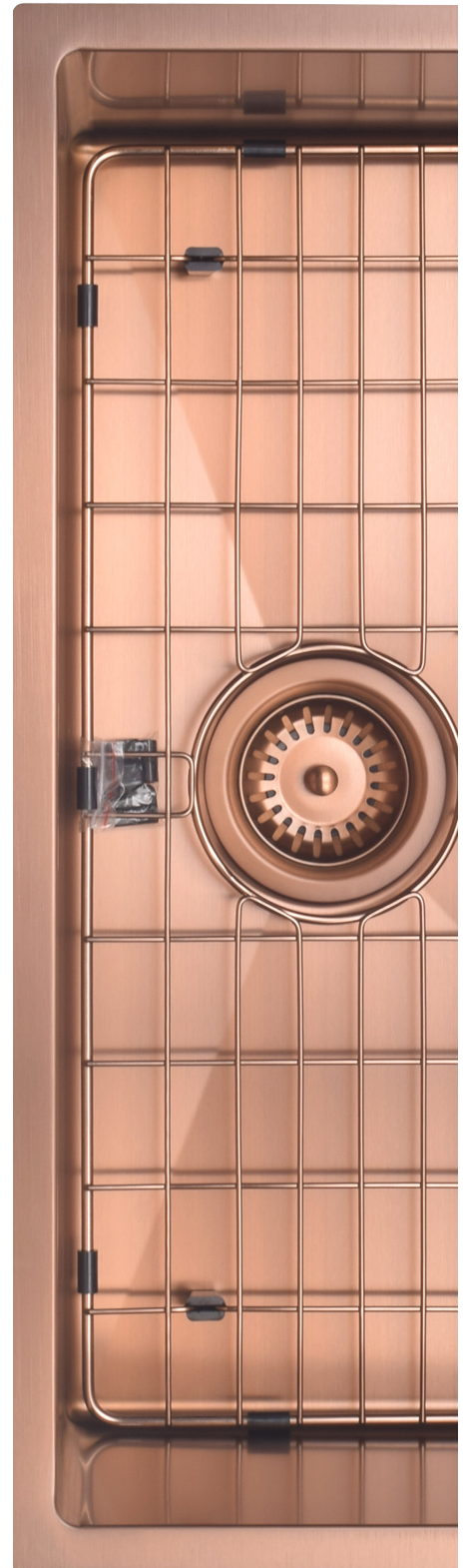

304 STAINLESS STEEL
ASPEN 600 SINGLE KITCHEN SINK

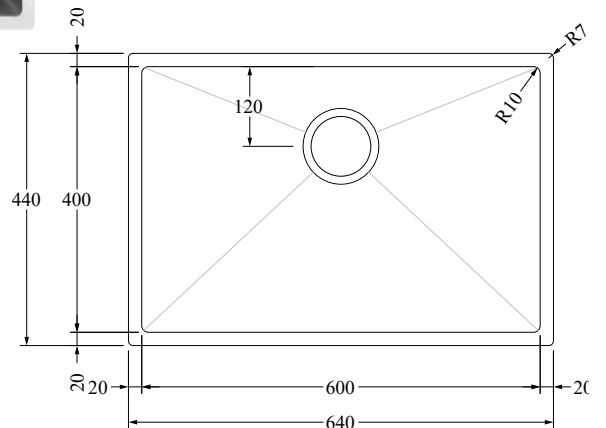
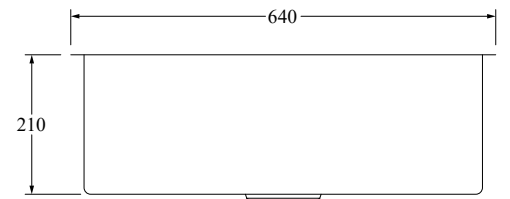
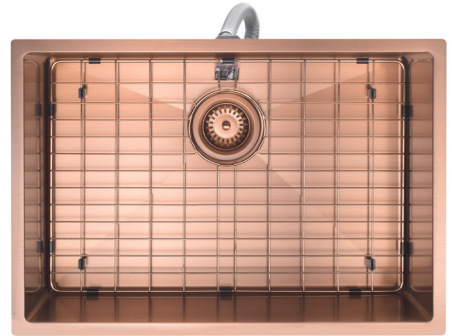

- 600w x 400h x 210d mm**
AS64BB Brushed Brass
AS64BC Brushed Copper
AS64GM Gun Metal
AS64MB Matte Black
AS64SS Stainless Steel

● 304 STAINLESS STEEL
●
● **ASPEN 700 SINGLE KITCHEN SINK**
●

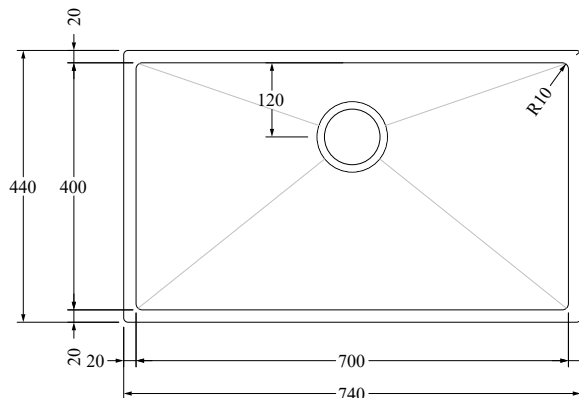
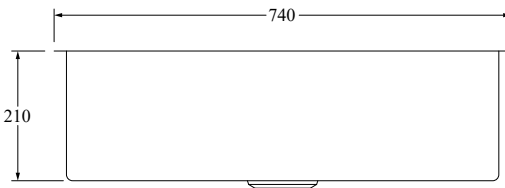
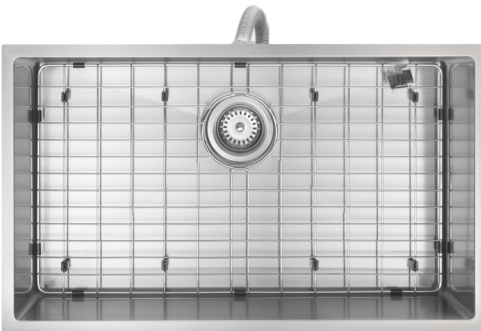
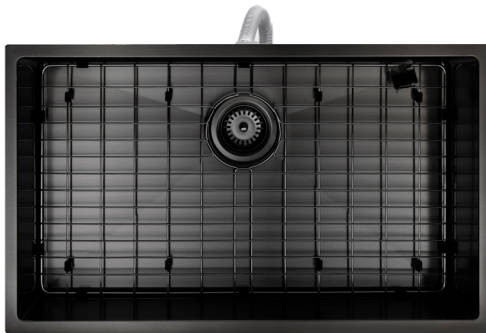
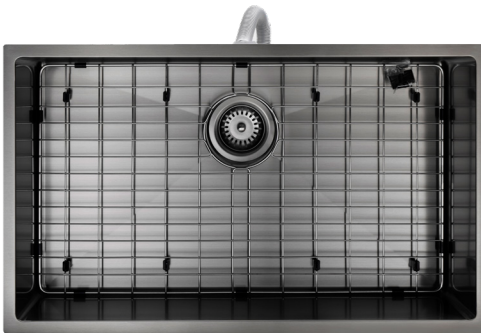
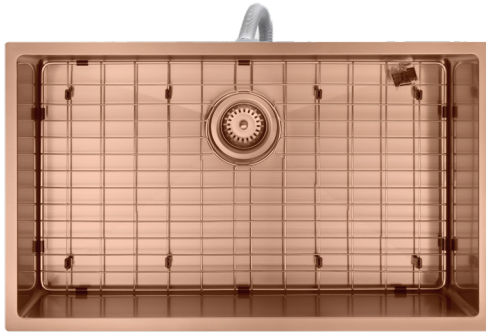
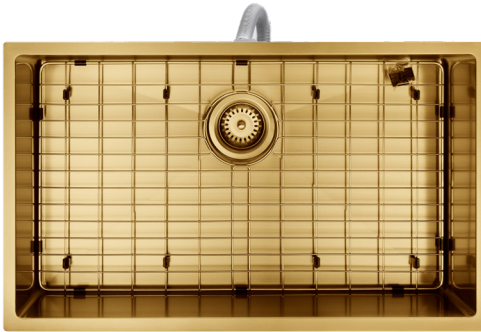

700w x 400h x 210d mm

- AS74BB Brushed Brass
- AS74BC Brushed Copper
- AS74GM Gun Metal
- AS74MB Matte Black
- AS74SS Stainless Steel



● 304 STAINLESS STEEL
●
● **ASPEN 520/200 DUAL KITCHEN SINK**
●

Please note: The dual kitchen sinks can only be installed via undermount installation and can be reversed left or right

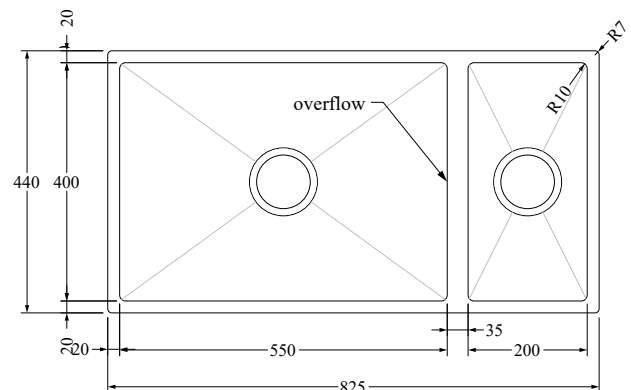
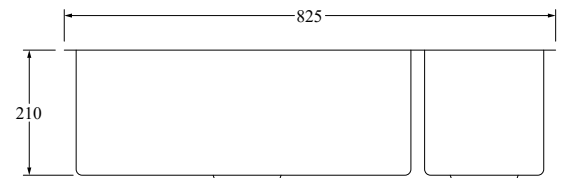
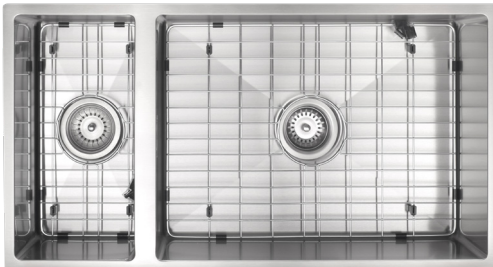
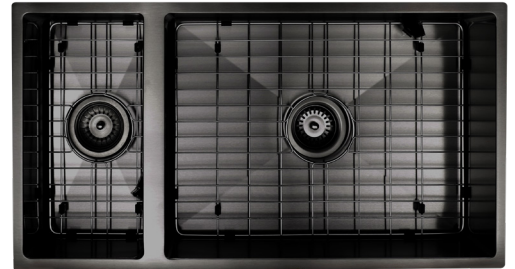
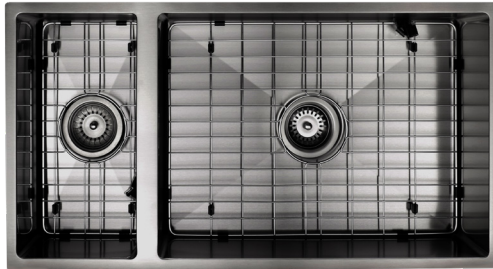
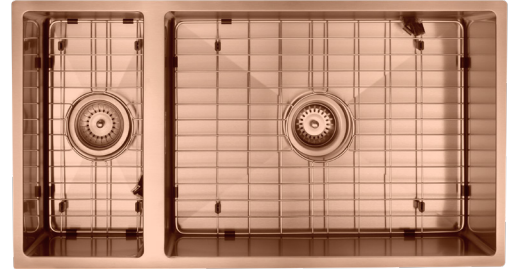
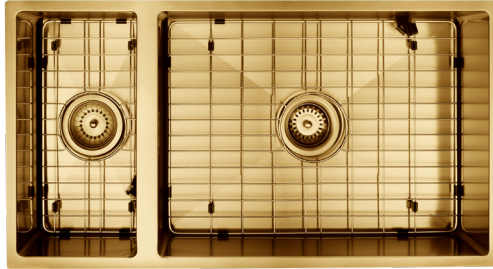
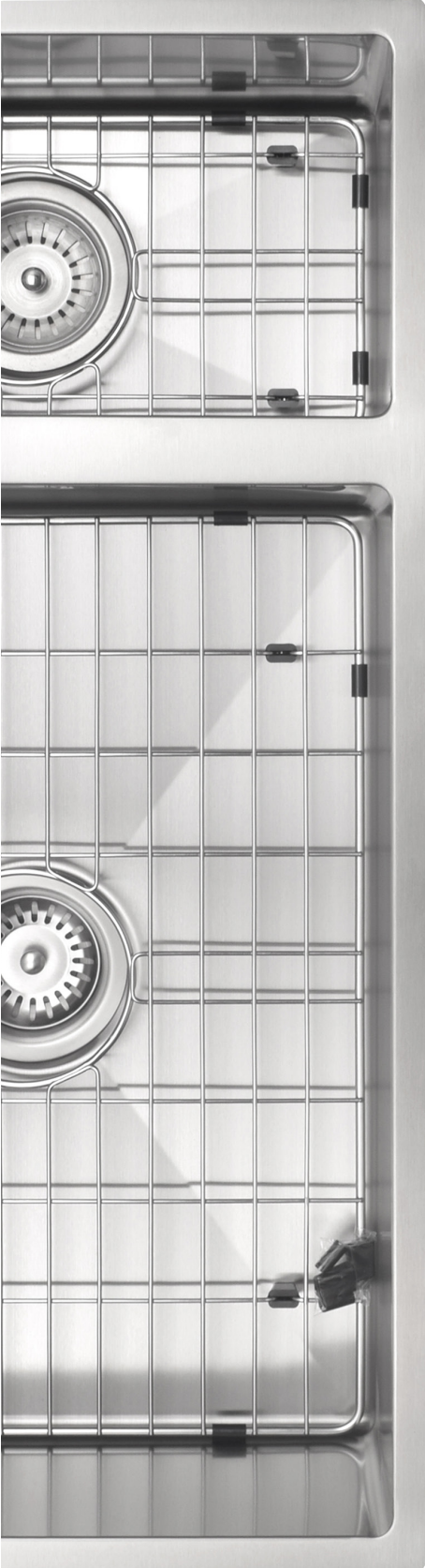

500/200 x 400 210d mm

- ASDBB Brushed Brass
- ASDBC Brushed Copper
- ASDGM Gun Metal
- ASDMB Matte Black
- ASDSS Stainless Steel

 KITCHEN MIXER
DOPPIA EXTRACTABLE

Doppia extractable kitchen mixer brings a high quality and modish touch to your kitchen. Our elegant design blends with any decor and complements any kitchen space.



FWK396GM *gun metal*
Doppia Extractable Kitchen Mixer,
388mm overall height x 226mm reach
WELS 5 Star 4.5L/min



FWK396BN *brushed nickel*
Doppia Extractable Kitchen Mixer,
388mm overall height x 226mm reach
WELS 5 Star 4.5L/min



FWK396BL *matte black*
Doppia Extractable Kitchen Mixer,
388mm overall height x 226mm reach
WELS 5 Star 4.5L/min



FWK396BG *brushed gold*
Doppia Extractable Kitchen Mixer,
388mm overall height x 226mm reach
WELS 5 Star 4.5L/min



FWK396BC *brushed copper*
Doppia Extractable Kitchen Mixer,
388mm overall height x 226mm reach
WELS 5 Star 4.5L/min

ASPEN
ACCESSORIES

Complete your kitchen with our collection of coloured sink accessories. The Aspen series has a complete range of air switches, hot mats and waste master collar and plugs to match your choice of kitchen sink.



Aspen filter tap

- AFT-BB Brushed Brass
- AFT-BC Brushed Copper
- AFT-BN Brushed Nickel
- AFT-CH Chrome
- AFT-GM Gun Metal
- AFT-MB Matt Black
- AFT-MW Matt White



Aspen Soap Dispenser

- ASD-BB Brushed Brass
- ASD-BC Brushed Copper
- ASD-BN Brushed Nickel
- ASD-CH Chrome
- ASD-GM Gun Metal
- ASD-MB Matt Black
- ASD-MW Matt White

ASPEN
ACCESSORIES

Complete your kitchen with our collection of coloured sink accessories. The Aspen series has a complete range of air switches, hot mats and waste master collar and plugs to match your choice of kitchen sink.

Aspen waste master

Air Switch - Universal 32mm

- CAS-BB Brushed Brass
- CAS-BC Brushed Copper
- CAS-GM Gun Metal
- CAS-MB Matt Black
- CAS-BS Brushed Stainless



Aspen Stainless steel Roll-up hot mat

480 x 480

- ASHM-BB Brushed Brass
- ASHM-BC Brushed Copper
- ASHM-GM Gun Metal
- ASHM-MB Matt Black
- ASHM-SS Brushed Stainless

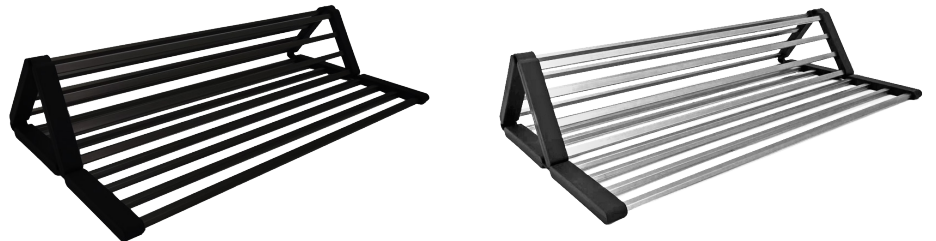

Aspen Universal waste master collar and plug

- ASFP-BB Brushed Brass
- ASFP-BC Brushed Copper
- ASFP-GM Gun Metal
- ASFP--MB Matt Black
- ASFP-BS Brushed Stainless



WHAT IS
NANO-COATING?



Anti-fingerprint nanocoating is an effective contribution to hygiene and appearance in kitchens or other hygienically critical areas.

Nano-Coating is a unique and innovative technology, which provides long lasting protection of all forms of stainless steel. The benefits include: durability, self-cleaning and anti-fingerprint.

The Nano-coating is a antimicrobial protective layer that is highly effective in preventing bacterial growth and the formation of biofilms. This coating can withstand treatment by harsh disinfectants, meaning that surfaces remain clean or can be cleaned with little effort. The surface remains clean or can be cleaned with little effort. In places that are difficult to access, a targeted jet of water is sufficient.

Corrosion Protection

Stainless steel does not mean that it is resistant to everything. To provide stainless steel with lasting protection against acids, bases and weathering, an additional sealant is a good idea. This creates a thick, very hard protective film that also offers good resistance to aggressive media.

How Surface Sealing Works

Nano-coating is a special silicon oxide powder which is applied to the surface of a product and cured with UV light. This process leaves the surface with an invisible, micro-rough structure. The microrough structure makes it impossible for dirt and water droplets to stick to the surface which can be very helpful in catering kitchens with their highly greasy fumes: instead of washing greasy films from cabinets with harsh detergents, simple water is sufficient in most cases. This reduces the need for harsh cleaning agents and thus protects the environment.

Advantages of Nano-coating



Improved hygiene

The micro-rough surface of nano coating ensures that dirt, grease and moisture can no longer adhere directly to the steel sheet.



Protection against oxidation

The nano coating also protects stainless steel from unwanted oxidation by chemicals.



Self-cleaning surface

Nano coating for stainless steel makes it particularly easy to clean. Grease splashes and other dirt are simply wiped off with a damp cloth.



Anti-fingerprint

With a Nano-coating sealant, fingerprints are significantly reduced.

WHAT IS
PVD?



Physical vapor deposition (PVD) is a collective name for vacuum deposition techniques used to produce thin films and coatings on various substrates.

The name of the method implies that the process involves changing matter from a solid or liquid phase to form a gas phase above the substrate, followed by condensation onto the substrate in order to form a film. During this process, the material undergoes chemical reactions and physical changes such as phase changes while passing through different states of aggregation.

- It does not require the use of chemical reagents or cleaning post-treatments, so it has a very low environmental impact.
- PVD can be applied to any type of inorganic material.
- The coatings obtained by PVD have great adhesion, resistance and durability.
- The PVD technique allows great control of the composition and thickness of the coatings.

Warranty

Residential	Warranty Period	Type
Aspen stainless steel sinks	10 Year Warranty	2 Years Parts & Labour + 8 Years Replacement Product
Filter Taps	2 Year Warranty	Replacement Product Only
Waste, grid and overflow	1 Year Warranty	Replacement Product Only
Aspen sink accessories	1 Year Warranty	Replacement Product Only
Commercial	Warranty Period	Type
Aspen stainless steel sinks	2 Year Warranty	1 Year Parts & Labour + 1 Years Replacement Product
Filter Taps	2 Year Warranty	Replacement Product Only
Waste,grid and overflow	1 Year Warranty	Replacement Product Only
Aspen sink accessories	1 Year Warranty	Replacement Product Only

WATERWARE

waterware.co.nz
info@waterware.co.nz
+64 9 273 9191

