



jaga
CLIMATE
DESIGNERS



MAXIMUM INDOOR COMFORT, MINIMUM CARBON EMISSION



WATERWARE
waterware.co.nz

ENERGY EFFICIENCY



The Jaga Climate Designer Briza range is a collection of heating and cooling solutions designed to provide optimal comfort and energy efficiency in buildings. These solutions incorporate innovative technology and sleek design to create a comfortable indoor climate while also saving energy.

The Briza range includes various options, such as radiators, convectors, and fan coil units, with different power outputs to fit different spaces and heating or cooling requirements. These units can be wall-mounted, floor-mounted, or installed in suspended ceilings, allowing for flexibility in placement.

One of the key features of the Briza range is its low water content, which enables quick response times and energy-efficient operation. The units are also designed for easy installation, maintenance, and cleaning, ensuring hassle-free operation and longevity.

In terms of control options, the Briza range offers various choices, including manual thermostats, wireless controls, and advanced smart control systems. These control options allow for precise temperature management and can be integrated with other building management systems for optimized comfort and energy savings.

Overall, the Jaga Climate Designer Briza range offers a range of heating and cooling solutions that prioritize comfort, efficiency, and flexibility in design and installation. Whether for residential or commercial applications, these solutions aim to create a comfortable indoor environment while minimizing energy consumption.

THE BRIZA RANGE

Overall, the Jaga Climate Designer Briza range offers energy-efficient, customizable, and aesthetically pleasing heating and cooling solutions that prioritize comfort, convenience, and sustainability.

- 1. Energy efficiency:** The Briza range is designed with low water content, ensuring quick response times and energy-efficient operation. This helps to reduce energy consumption and lower heating and cooling costs.
- 2. Comfort control:** The Briza units provide precise temperature management, allowing for individual control and customization of the indoor climate. This ensures optimal comfort for occupants.
- 3. Sleek design:** The Briza range features a modern and sleek design that seamlessly integrates into any interior space. The units are available in variety of sizes and styles, offering flexibility in placement and aesthetic appeal.
- 4. Easy installation and maintenance:** The Briza units are designed for easy installation, maintenance, and cleaning. This ensures hassle-free operation and prolongs the lifespan of the units.
- 5. Versatility:** The Briza range offers a variety of options, including radiators, convectors, and fan coil units, with different power outputs and mounting options. This allows for flexibility and customization to fit different spaces and heating or cooling requirements.
- 6. Control options:** The Briza range offers a range of control options, from manual thermostats to advanced smart control systems. This allows for precise temperature management and integration with other building management systems for optimized comfort and energy savings.
- 7. Environmentally friendly:** The Briza range is designed with sustainability in mind. The low water content and energy-efficient operation contribute to reduced carbon emissions and a smaller environmental footprint.

Overall, the Jaga Climate Designer Briza range offers energy-efficient, customizable, and aesthetically pleasing heating and cooling solutions that prioritize comfort, convenience, and sustainability.

JAGA

BRIZA 12

Compact and quiet fan convector in a slim design or for built-in installation

Briza is the best solution if you want to combine power with a sleek design.

Jaga Briza fan convectors ensure the highest climate comfort while being energy-efficient and whisper-quiet

They bring every room up to temperature very quickly, both in winter and in summer. This way you can enjoy an ideal indoor climate year-round.

- Also for residential projects
- Built-in EC motor for a much lower energy consumption and a longer service life
- Suitable for connection to any heat source
- Ideal in combination with heat pumps and low temperature systems
- Optimized cooling capacity due to the new hydrophilic protection of the copper-aluminum coil.
- With built-in room thermostat or controllable via the latest home automation systems
- For -pipe or -pipe
- Also available in a ceiling model or for in wall or in-ceiling installation



JAGA

BRIZA 22

Easy to install fan convector for in-wall or in-ceiling installation Super-power for heating, cooling and ventilation

Briza 22 is the most powerful ventilo-convector for exhibition and retail spaces, once and meeting rooms, school buildings, hotels, winter gardens, etc. Jaga Briza fan convectors ensure the highest climate comfort while being energy efficient and whisper-quiet. They bring every room up to temperature very quickly, both in winter and in summer. This way you can enjoy an ideal indoor climate year-round.

- The Briza 22 is a high-quality heat pump with built-in EC motor. This makes it perfect for connection to any heat source and ideal in combination with heat pumps and low temperature systems. The [product name] has an optimized cooling capacity due to the new hydrophilic protection of the copperaluminum coil, which makes it suitable for non-condensing and condensing cooling in combination with any heat pump that has a cooling function.

Briza 22 comes with built-in room thermostat or can be controlled via the latest home automation systems. It has a two-pipe system for cooling or heating through a single water-side circuit, as well as -pipe system for cooling and heating through two water-side circuits.

- Also available for in-ceiling installation.



JAGA

BRIZA 12 - WITH CASE

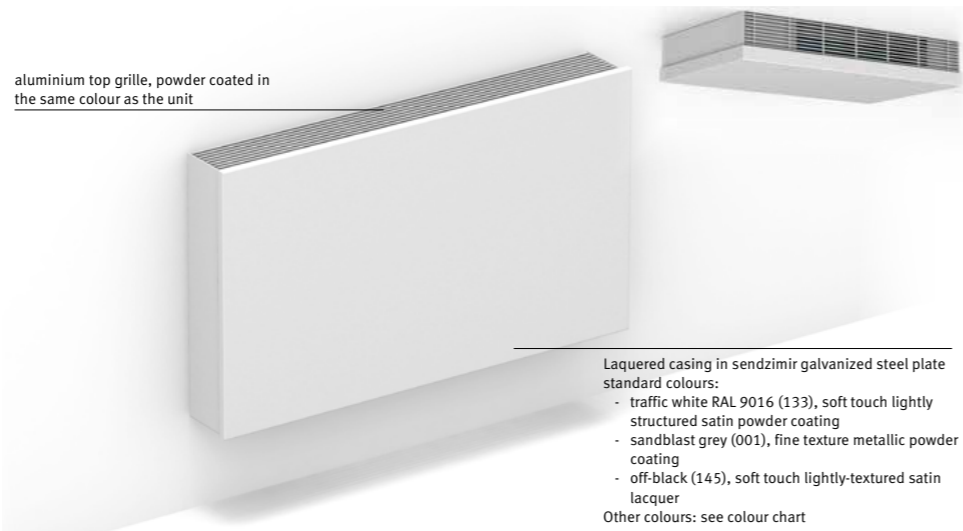

WALL MOUNTED DIMENSIONS (in cm)

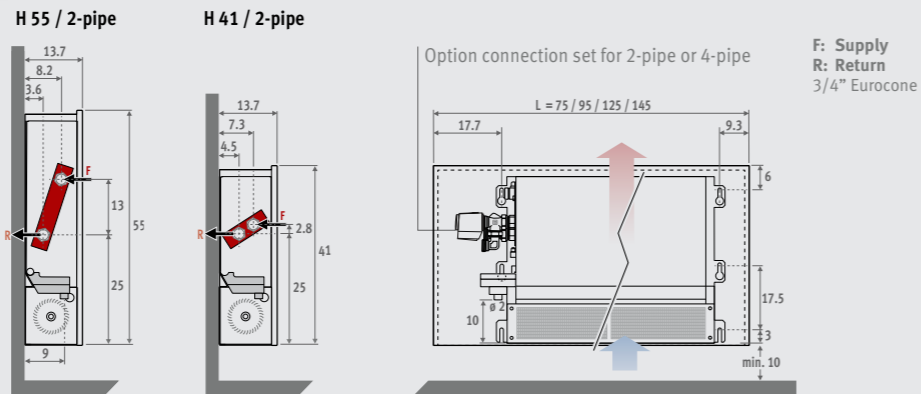

CEILING MOUNTED DIMENSIONS (in cm)

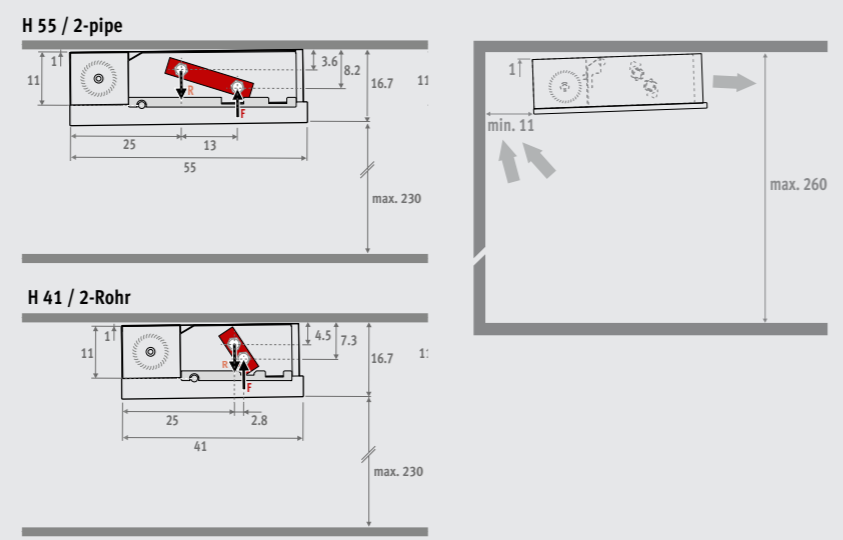

JAGA

BRIZA 12 - WITH CASE



Specifications

STANDARD DELIVERY

- Tangential activators with aluminium fins, ball bearings and resin-coated EPDM vibration damping
- Stainless steel air filter
- Condensation tray with drain
- Copper-aluminum -pipe hydrophilic coated heat exchanger, G / " F.
- Sturdy casing manufactured from electro-galvanised steel.

CONNECTION

- Standard connection:
- Hydraulic connection 3/4" Eurocone left
 - Clamp connector for electric connection VDC, to connect via an external power supply, on the right hand side.
- Other connection:
- Hydraulic right, electric left :
Connection code/70instead of/ 20 No surcharge .



DIMENSIONS	CONTROL VOLTAGE	HEATING ROOM TEMPERATURE 20°C				COOLING TOTAL ROOM TEMPERATURE 27°C		COOLING SENSIBLE ROOM TEMPERATURE 27°C	COOLING Non-condensing ROOM TEMPERATURE 27°C	SOUND PRESSURE*	AIR FLOW	ELECTRIC POWER CONSUMPTION	
		75/65	55/45	45/35	35/30	7/12	7/12	16/18					
H	L	T	U	Watts	Watts	Watts	Watts	Watts	dB(A)	m³/h	Watts		
095	12	2	2	2250	1350	881	555	730	517	295	23	127	2
		4	4	2781	1668	1089	686	875	626	358	28	193	4
		6	6	3309	1985	1295	816	1029	746	426	34	262	6
		8	8	3816	2290	1494	941	1176	862	492	40	320	10
		10	10	4285	2571	1678	1057	1298	963	550	44	365	16
145	12	2	2	4509	2705	1765	1112	1460	1033	590	25	200	3
		4	4	5525	3315	2163	1363	1734	1242	709	31	297	6
		6	6	6588	3953	2579	1625	2037	1476	843	38	396	10
		8	8	7615	4569	2981	1878	2332	1710	977	43	500	18
		10	10	8526	5115	3338	2103	2584	1917	1095	47	583	29

JAGA

BRIZA 12 - WITHOUT CASE



BZBW INSTALLATION IN A WALL RECESS

Hydraulic connection
2-pipe 1/2"
4-pipe 1/2"

Sturdy casing manufactured from electro-galvanised steel

Heat exchanger with hydrophilic coating for optimum cooling performance

Metal condensate tray with epoxy-polyester coating

Tangential fans

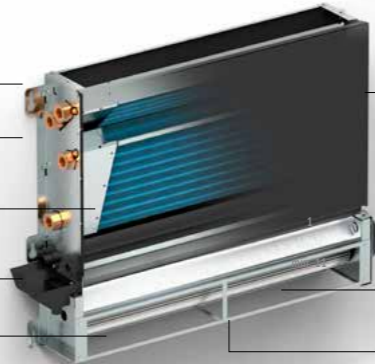

BZBC BUILT-IN CEILING



Electrical connection



EC motor 24 VDC

Stainless steel air filter

max. 260
Mounting of the fan blade using dust/oil-free ball bearings

WALL MOUNTED DIMENSIONS (in cm)

H 52 / 2-pipe

H 38 / 2-pipe

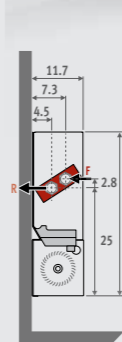
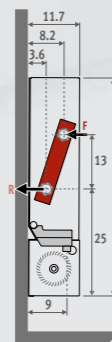

Option connection set for 2-pipe

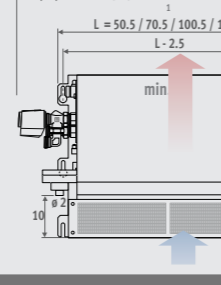

Built-in model with air outlet corner piece

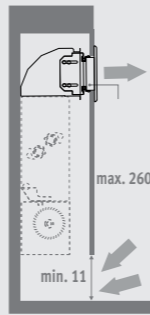

CEILING MOUNTED DIMENSIONS (in cm)

H 55 / 2-pipe

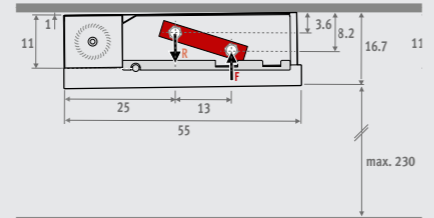

H 41 / 2-Rohr

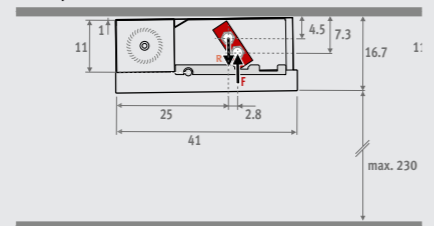

Built-in model with air outlet corner piece

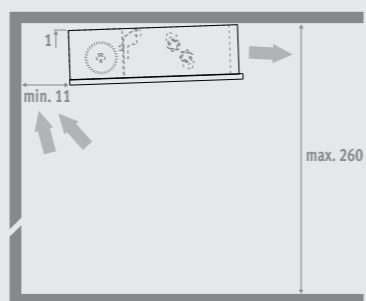

Specifications

STANDARD DELIVERY

- Tangential activators with aluminium fins, ball bearings and resin-coated EPDM vibration damping
- Stainless steel air filter
- Condensation tray with drain
- Copper-aluminum -pipe hydrophilic coated heat exchanger, G / " F.
- Sturdy casing manufactured from electro-galvanised steel.

CONNECTION

- Standard connection:
- Hydraulic connection 3/4" Eurocone left
 - Clamp connector for electric connection VDC, to connect via an external power supply, on the right hand side.
- Other connection:
- Hydraulic right, electric left :
Connection code/70 instead of /20 No surcharge .



BZBW Installation in a wall recess

BZBC Built-in ceiling

2-PIPE

DIMENSIONS	CONTROL VOLTAGE	HEATING ROOM TEMPERATURE 20°C				COOLING TOTAL ROOM TEMPERATURE 27°C		COOLING SENSIBLE ROOM TEMPERATURE 27°C	COOLING (Non-condensing) ROOM TEMPERATURE 27°C	SOUND PRESSURE* dB(A)	AIR FLOW m³/h	ELECTRIC POWER CONSUMPTION Watts
		H	L	T	U	7/12	7/12	16/18				
072	12	2	2465	1479	965	608	790	559	319	22	127	2
		4	2931	1759	1148	723	922	660	377	27	193	4
		6	3499	2099	1370	863	1073	778	444	35	262	6
		8	4011	2406	1570	989	1226	899	513	41	320	10
		10	4499	2699	1761	1110	1362	1010	577	45	365	16
122	12	2	4652	2791	1821	1148	1550	1096	627	26	200	3
		4	5794	3476	2268	1429	1823	1305	746	32	297	6
		6	6924	4154	2711	1708	2149	1557	890	39	396	10
		8	7994	4796	3130	1972	2439	1788	1022	45	500	18
		10	8954	5373	3506	2209	2711	2011	1149	49	583	29



JAGA

BRIZA 12 - WITHOUT CASE

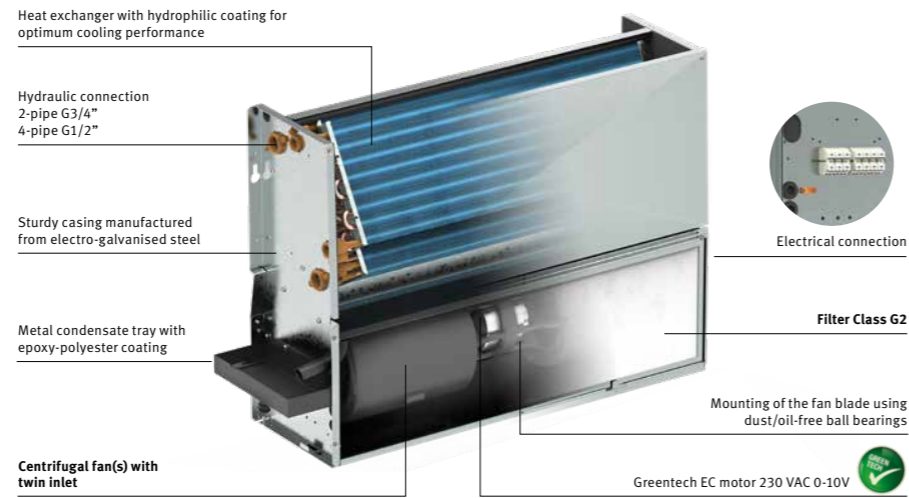

INSTALLATION IN A WALL RECESS BABW

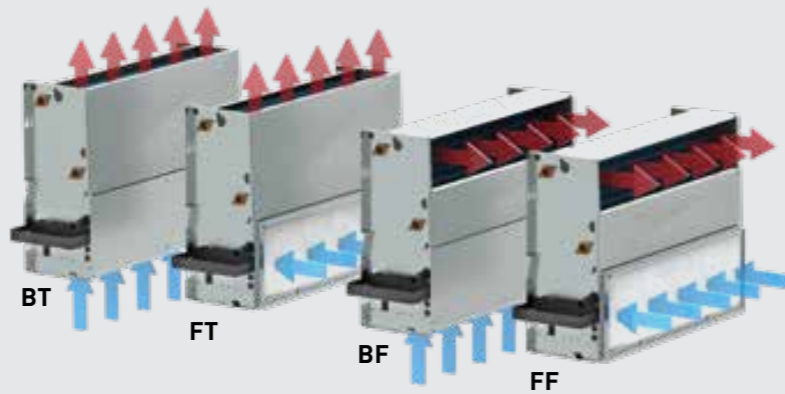

INSTALLATION IN CEILING BABC

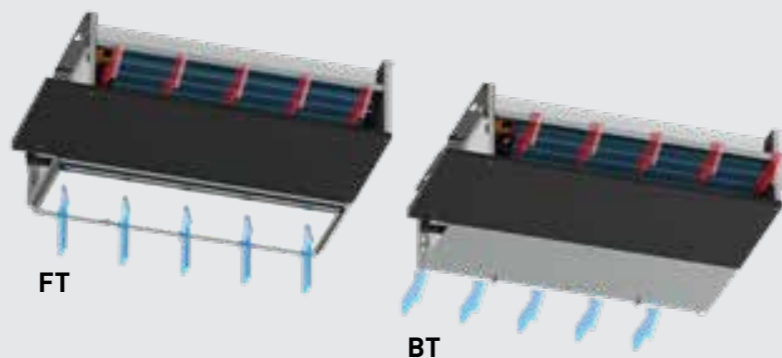

Specifications

STANDARD DELIVERY

- Energy efficient and maintenance-free
- EC motor
- Centrifugal fan(s) with twin inlet
- Copper-aluminum 2-pipe hydrophilic coated heat exchanger, G3/4" F.
- Condensate tray with outlet spigot \varnothing 2 cm
- Replaceable polypropylene dust filter (class G)
- Sturdy casing manufactured from electro-galvanised steel

CONNECTION

- Standard connection :
- Hydraulic connections on the left hand side, clamp connector for electric connection 230 VAC on the right hand side.
- OTHER CONNECTION
- Hydraulic right, electric left: Connection code/70 instead of/ 20 No surcharge .
- ex.BABW.055 055 22/BT/70

DIMENSIONS			MAX. MEASURED CURRENT	CONTROL VOLTAGE	HEATING ROOM TEMPERATURE 20°C				COOLING TOTAL ROOM TEMPERATURE 27°C		COOLING SENSIBLE ROOM TEMPERATURE 27°C	COOLING [Non-condensing] ROOM TEMPERATURE 27°C	SOUND PRESSURE*	AIR FLOW	POWER CONSUMPTION
H	L	T			I	U	75/65	55/45	45/35	35/30	7/12	7/12			
cm	cm	cm	A	V	Watts	Watts	Watts	Watts	Watts	Watts	Watts	Watts	dB(A)	m ³ /h	Watts
075	22	0.5	2	2	3010	1814	1204	766	1445	1041	508	21	178	3.7	
			4	4	5307	3197	2124	1350	2475	1784	870	30	327	8.8	
			6	6	7026	4233	2811	1787	3258	2348	1146	39	456	17.7	
			8	8	8409	5067	3365	2139	3901	2811	1372	45	579	31.9	
			10	10	9370	5646	3749	2384	4358	3141	1533	49	681	46.4	
095	22	0.5	2	2	4049	2377	1546	960	1882	1356	747	22	247	3.9	
			4	4	6960	4086	2657	1650	3189	2298	1266	30	413	9.9	
			6	6	9281	5448	3543	2200	4221	3042	1675	37	565	20.6	
			8	8	11143	6541	4254	2642	5040	3632	2000	43	707	35.9	
			10	10	12305	7223	4698	2918	5543	3995	2200	47	809	51.2	
155	22	1.0	2	2	4889	2946	1956	1244	2420	1393	680	25	392	7.2	
			4	4	9374	5648	3751	2385	4358	2978	1453	34	706	17.8	
			6	6	13215	7962	5288	3362	6048	4325	2110	41	990	37.1	
			8	8	16591	9996	6639	4221	7562	5499	2683	47	1252	65.8	
			10	10	18859	11363	7547	4797	8596	6282	3065	51	1436	95.0	



JAGA

BRIZA 12 - GRILLES (WALL & CEILING)

JAGA

BRIZA 12/22 - OPTIONS

ALUMINIUM ADJUSTABLE SLOT DIFFUSER:

- Sleek design with discrete aluminium deflectors, slot width 25mm.
- Easy mounting with mounting brackets.
- Wide temperature range for both heating and cooling

The adjustable slot diffuser is suitable for the supply and exhaust of cooled and heated air. Each slot is individually adjustable and is equipped with 2 specially designed discrete deflectors (slit width 25mm). This results in an ideal air flow pattern that can be adjusted by 180° (vertical and horizontal air flow).

Application	Airflow direction:	lateral, axial, adjustable
	Airflow type:	linear, exhaust or supply
Construction	Frame size:	20 mm
	Slot width:	25 mm
Material	Standard material:	extruded aluminium, satin anodized 11µm
	Finishing:	powder coating RAL 9003
	Deflectors:	powder coated extruded aluminium, black
	Deflector fixation piece:	synthetic
Mounting:	with mounting brackets	

Parts:

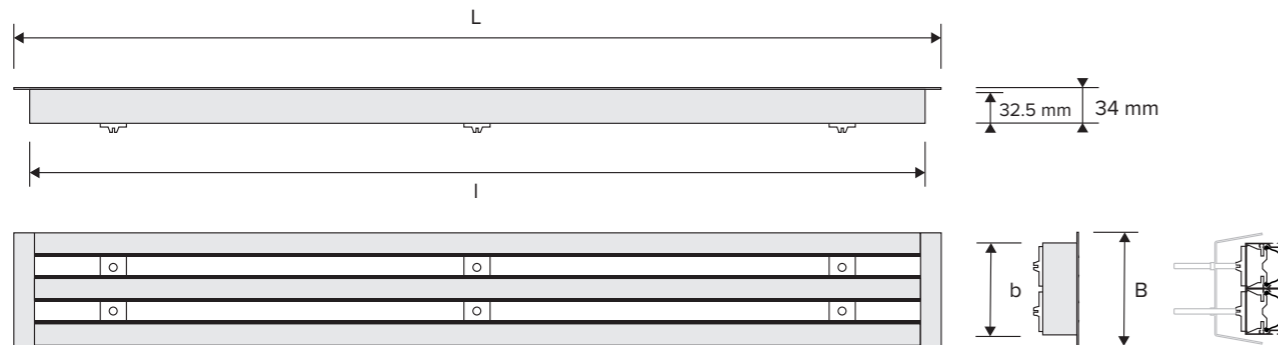
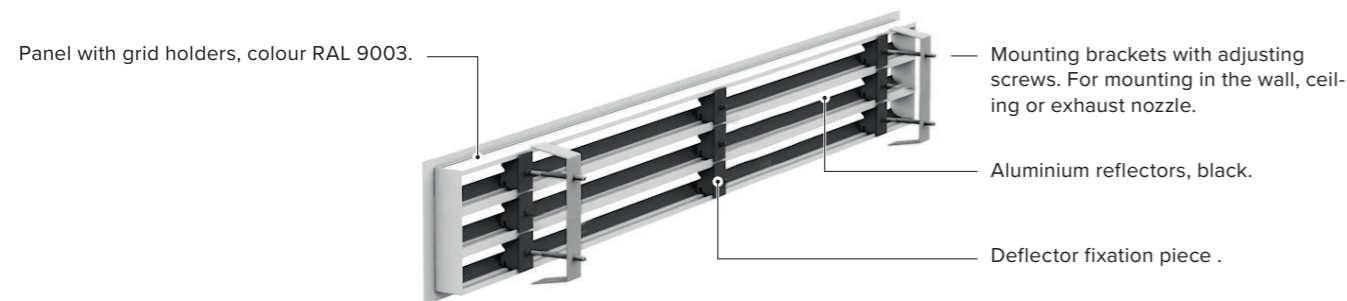

Briza 12	Frame external dimensions		Rame internal dimensions	
	Length (L)	Width (B)	Length (L)	Width (B)
T2 / 072	595	11	55.5	9
T4 / 122	109	11	105.5	9

CORNER PIECE 90°

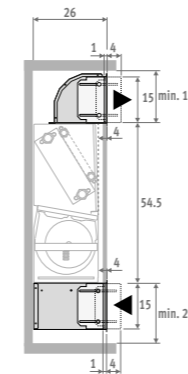

AIR INLET CORNER PIECE 90°

- Height control -1 to + 4 cm
- Galvanised steel plate

CODE	Length Briza 22	€
8787.0101	55	97
8787.0102	75	103
8787.0103	95	112
8787.0104	125	128
8787.0105	155	152

AIR OUTLET CORNER PIECE 90°

- Height control -1 to + 4 cm
- Galvanised steel plate

CODE	Length Briza 22	€
8788.0101	55	90
8788.0102	75	97
8788.0103	95	112
8788.0104	125	117
8788.0105	155	143

GRILLE FOR CORNER PIECE 90°

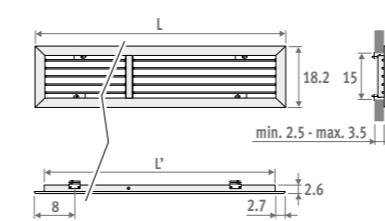

CODE	L Briza 22	Building in-opening	€
8789.201	55	50 x 15	108
8789.202	75	70 x 15	132
8789.203	95	90 x 15	170
8789.204	125	120 x 15	195
8789.205	155	150 x 15	227

PLENUM 180°

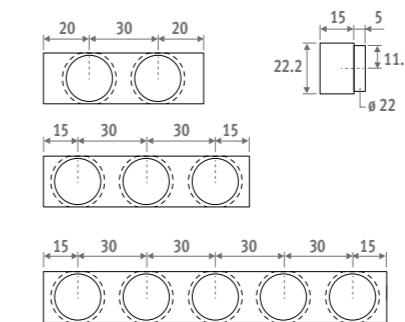
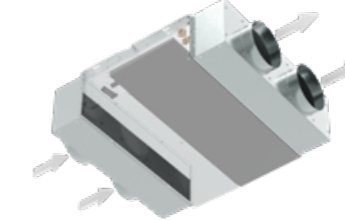

AIR INLET PLENUM 180°

- Connection Ø 20 cm
- To fit on the air inlet side
- Galvanised steel plate

CODE	L Briza 22	# Connections	€
8764.0502	75	2	95
8764.0503	95	3	111
8764.0505	155	5	154

AIR EXHAUST PLENUM 180°

- Connection Ø 20 cm
- To fit on the air exhaust side
- Acoustically and thermally insulated internal surfaces
- Galvanised steel plate

CODE	L Briza 22	# Connections	€
8764.0602	75	2	149
8764.0603	95	3	182
8764.0605	155	5	244



jaga
CLIMATE
DESIGNERS

WATERWARE

waterware.co.nz
info@waterware.co.nz
+64 9 273 9191

